



# 12LCP-12

12V 13Ah



Q-Batteries Akku 12LCP-12 battery is a special deep cycle battery which is designed for intensive cyclic discharge usage. Because of the very thick lead plates it's possible to achieve more cycles and longer lifetime.

## Application:

Electric wheelchair, caravan/marine, cleaning machines, golf cart, vehicle lifts, solar energy system, u.v.m.

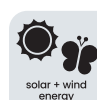

## Specification:

Voltage Per Unit	12 V		
Capacity	13 Ah @20hr-rate to 1.8V per cell @25°C		
Cells Per Unit	6		
Weight	ca. 3.5 kg +/- 3%		
Max. Discharge Current	180 A (5 sec.)		
Internal Resistance	ca. 19 m Ω		
Operating Temperature Range	Discharge:	Charge:	Storage:
Normal	- 15°C – 50°C	-10°C – 50°C	- 20°C – 50°C
Operating Temperature Range	25°C ± 5°C		
Self Discharge	Valve Regulated Lead Acid (VRLA) batteries can be stored for more than 6 months at 25°C. Self-discharge ratio less than 3% per month at 25°C. Please charge batteries before using.		
Terminal	F2 (Faston 6,35mm)		
Container Material	A.B.S. (UL94-HB)		

## Dimensions:

151 Length x 98 Width x 95 mm Height

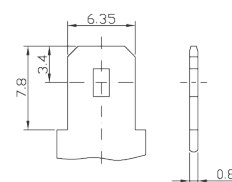
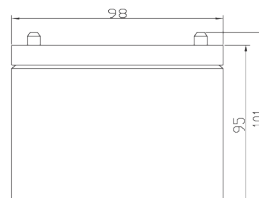
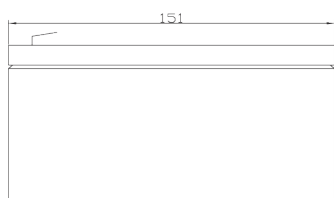

## Constant current discharge characteristics: A (25°C)

F.V / Time	5min	10min	15min	30min	60min	2h	3h	4h	5h	10h	20h
9.60V	46,50	29,30	23,00	12,80	7,89	4,30	3,09	2,47	2,09	1,15	0,62
9.90V	45,10	28,50	22,50	12,60	7,77	4,27	3,07	2,45	2,09	1,13	0,61
10.2V	43,20	27,30	21,60	12,20	7,56	4,23	3,03	2,43	2,07	1,13	0,61
10.5V	41,30	26,20	20,90	11,90	7,41	4,17	3,02	2,42	2,06	1,11	0,60
10.8V	39,10	24,70	19,90	11,50	7,17	4,06	2,93	2,35	1,99	1,10	0,59

## Life characteristics of cyclic use:

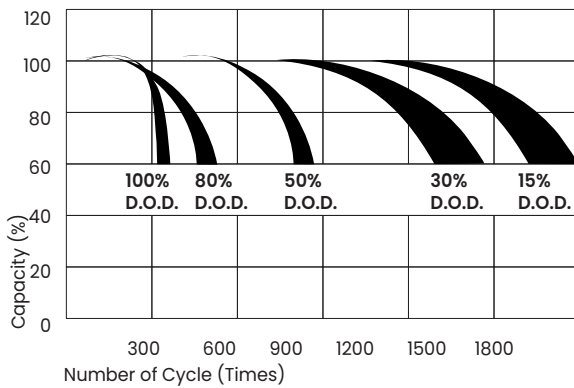

## Storage characteristic:

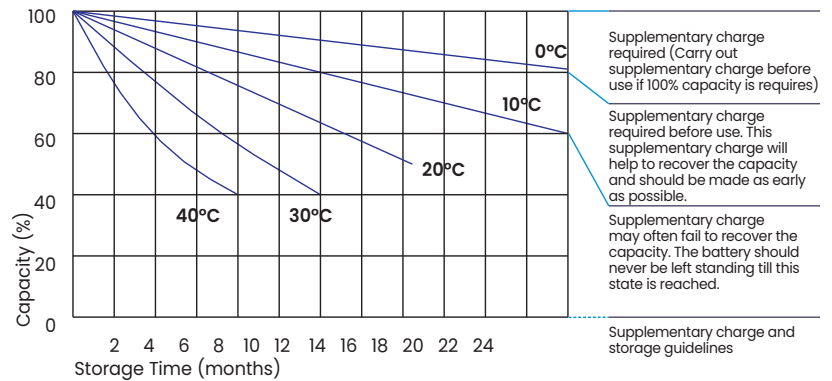

## Capacity Factors with different Temperature:

Batterie Type		-20°C	-10°C	0°C	5°C	10°C	20°C	25°C	30°C	40°C	45°C
GEL Battery	6V & 12V	50%	70%	83%	85%	90%	98%	100%	102%	104%	105%
	2V	60%	75%	85%	88%	92%	99%	100%	103%	105%	106%
AGM Battery	6V & 12V	46%	66%	76%	83%	90%	98%	100%	103%	107%	109%
	2V	55%	70%	80%	85%	92%	99%	100%	104%	108%	110%